

**SURVEYOR'S STATEMENT**

THIS MAP CORRECTLY REPRESENTS A SURVEY MADE BY ME OR UNDER MY DIRECTION IN CONFORMANCE WITH THE REQUIREMENTS OF THE PROFESSIONAL LAND SURVEYOR'S ACT AT THE REQUEST OF VAN DEN BERG AND SPERAW IN DECEMBER 2014.

*Douglas J. Scranton*

DOUGLAS J. SCRANTON P.L.S. NO. 5379  
EXPIRATION DATE: JUNE 30, 2016

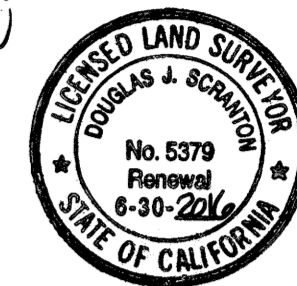

**COUNTY SURVEYOR'S STATEMENT**

THIS MAP HAS BEEN EXAMINED IN ACCORDANCE WITH SECTION 8766 OF THE PROFESSIONAL LAND SURVEYOR'S ACT THIS 29 DAY OF JULY, 2015.

*Richard G. Simonitch*  
RICHARD G. SIMONITCH  
MARIN COUNTY SURVEYOR

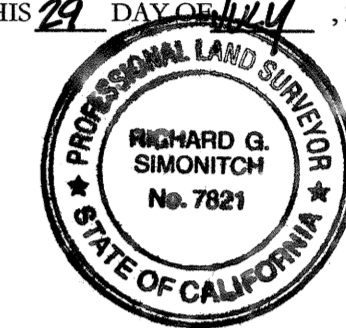

29th July, 2015

DEPUTY

**COUNTY RECORDER'S STATEMENT**

FILED THIS 21st DAY OF JULY 2015 AT 2:00 P.M., IN BOOK 2015 OF MAPS, AT PAGE 112 AT THE REQUEST OF THE MARIN COUNTY DEPARTMENT OF PUBLIC WORKS.

FEE: \$10 SERIAL NO. 2015-37332

RICHARD N. BENSON BY: *R.N.B.*  
MARIN COUNTY RECORDER DEPUTY

**BASIS OF BEARINGS**

TAKEN AS SOUTH 81°29'11"E EAST FROM POINT "A" TO POINT "B" AS SHOWN HEREON AND AS SAID BEARING WAS CALCULATED FROM R1.

ALL DIMENSIONS GIVEN IN FEET AND DECIMALS THEREOF

**REFERENCES**

- R1 4 MAPS 74
- R2 18 OS 96
- R3 D.N. 2000-032034
- R4 NON-RECORDED JC OGLESBY SURVEY No. 12859, AUGUST 1953 FOR WALTER CAMMIECIA A COPY OF WHICH IS AVAILABLE AT THE OFFICE OF WM. SCHROEDER, PLS 5814

**UNRECORDED REFERENCE MATERIAL STATEMENT**

THIS MAP CONTAINS A REFERENCE TO AN UNRECORDED DOCUMENT (R4) AND THE COUNTY SURVEYOR'S OFFICE IS UNABLE TO VERIFY COMPLIANCE WITH PORTIONS OF GOVERNMENT CODE SECTION 8766 SPECIFICALLY RELATED TO R4. NONETHELESS, THIS SURVEY IS FILED AT THE REQUEST OF THE SURVEYOR IN ACCORDANCE WITH GOVERNMENT CODE SECTION 8786.

**DETAIL TWO NOT TO SCALE**

- LEGEND**
- STANDARD STREET MONUMENT
  - FOUND MONUMENTATION AS NOTED
  - SET 1/2" REBAR/PLS CAP 5379
  - ⊙ SET BRASS NAIL WITH BRASS TAG STAMPED PLS 5379
  - MEAS. MEASURED
  - CALC. CALCULATED
  - ( ) RECORD DIMENSION
  - DENOTES LINE NOT DRAWN TO SCALE

**RECORD OF SURVEY  
LANDS OF VAN DEN BERGH AND SPERAW**

PER D.N. 2014-038104  
BEING LOTS 56 AND 57  
(IN BLOCK 2)

MAP No. 1 OF THE CASCADES  
BLOCKS 2 & 5 4 MAPS 74  
FAIRFAX MARIN COUNTY CALIFORNIA  
SCALE 1"=30 FEET JANUARY 2015  
SHEET ONE OF ONE

PREPARED BY  
DJ SCRANTON SURVEYING  
PO BOX 750818  
PETALUMA CA. 94975  
EMAIL: DJSURVEY4U@YAHOO.COM